

ADDENDUM No. 2 TO ORIGINAL INVITATION TO BID

DATE: September 28, 2018

BID No.: 5549-2019 Milling and Resurfacing of Tennis Courts at Chiles High School

BID Opening: October 9, 2018 @ 2:00 P.M. EST (*Addendum does not change the Bid due date*)

This addendum is being issued to make the following changes, corrections, clarifications and additions to the bidding document. The information in this addendum modifies and changes the original bidding document and takes precedence over the original document. Receipt of this addendum shall be acknowledged by the bidder signing and dating below and submitting this document with your bid proposal form. Failure to acknowledge this addendum may preclude consideration of the bid proposal for award.

ADDITIONAL SCOPE OF WORK

2. THE EXISTING FENCE POST AND TENNIS NET POST BASES WILL BE REMOVED BY THE LEON COUNTY SCHOOL BOARD. THE HOLES ARE TO BE FILLED WITH BASE AND MEET THE COMPACTION REQUIREMENTS OF FDOT STANDARD SPECIFICATIONS SECTION 285 OPTIONAL BASE GROUP 4. THE LEON COUNTY SCHOOL BOARD WILL BE RESPONSIBLE FOR PAYING AND SCHEDULING ALL MATERIAL TESTING.
3. THE CONTRACTOR IS TO FULLY RESTORE ANY AND ALL DAMAAGE TO THE CHILES HIGH SCHOOL PROPERTY DUE TO CONSTRUCTION ACTIVITY TO PRE-CONSTRUCTION CONDITIONS.

SEE ATTACHED

***TO QUALIFY YOUR PROPOSAL, OF WHICH THIS ADDENDUM BECOMES A PART,
RECEIPT OF IT SHOULD BE ACKNOWLEDGED AND RETURNED WITH YOUR PROPOSAL.***

VENDOR NAME

VENDOR ADDRESS

NAME

TITLE

SIGNATURE

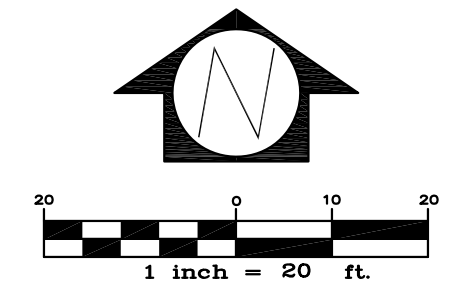
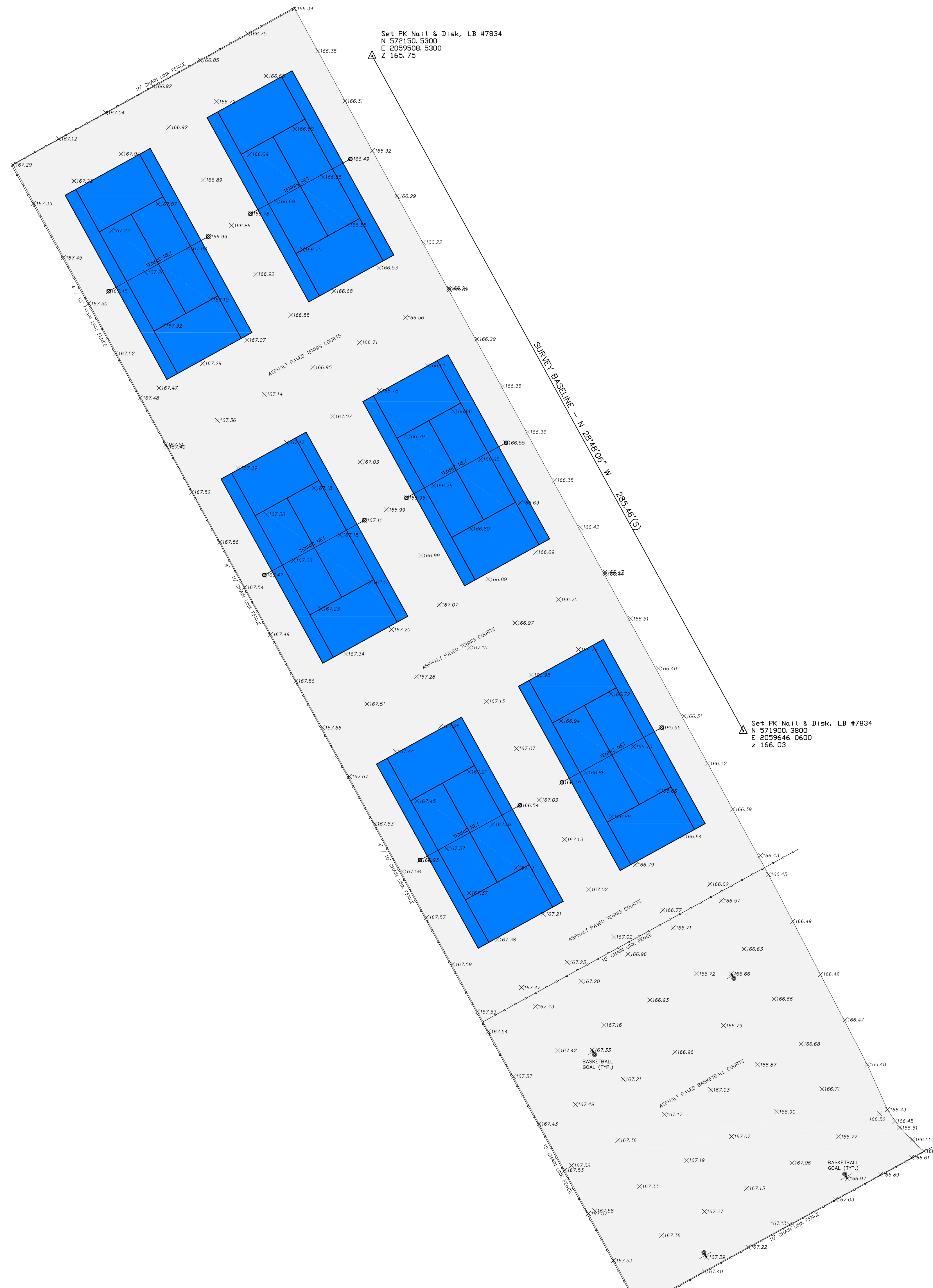



LEGEND / SYMBOLS

N	-	NORTHING STATE PLANE COORDINATE
E	-	EASTING STATE PLANE COORDINATE
Z	-	ELEVATION
X 166.25	-	SPOT ELEVATION

- NOTES**
1. THIS IS NOT A BOUNDARY SURVEY. THE BOUNDARY SHOWN
 2. THE INTENT OF THIS SURVEY IS TO PORTRAY THE EXISTING CONDITIONS OF THE TENNIS COURTS AT CHILES HIGH SCHOOL IN LEON COUNTY, FLORIDA.
 3. HORIZONTAL LOCATION IS BASED ON STATE PLANE COORDINATES ESTABLISHED USING THE FLORIDA PERMANENT REFERENCE NETWORK (FPRN) SUPPORTED BY THE FLORIDA DEPARTMENT OF TRANSPORTATION, NAVD83 HORIZONTAL DATUM, FLORIDA NORTH PROJECTION. THE ELEVATIONS SHOWN HEREON ARE BASED ON NAVD83 VERTICAL DATUM.
 4. ALL MEASUREMENTS ARE IN U.S. SURVEY FEET.
 5. THIS SURVEY IS NOT VALID WITHOUT THE SIGNATURE AND ORIGINAL RAISED SEAL OF A FLORIDA LICENSED SURVEYOR AND MAPPER.

© DAVID H. MELVIN, INC. ALL RIGHTS RESERVED. NO PART OF THIS DOCUMENT MAY BE REPRODUCED OR UTILIZED IN ANY FORM WITHOUT PRIOR WRITTEN PERMISSION OF DAVID H. MELVIN, INC.

LEGEND

-  ASPHALT TO BE MILLED
-  ASPHALT TO REMAIN

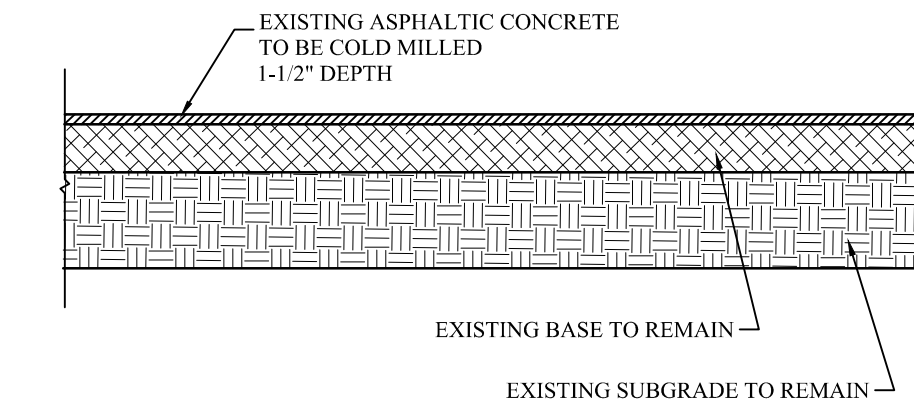
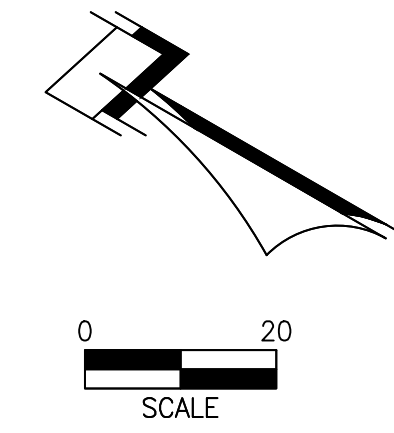

ASPHALT MILLING DETAIL
 A
 C1.1
 NTS

GENERAL NOTE:

1. THE EXISTING FENCES THAT RUN SOUTHWEST TO NORTHEAST AND TENNIS COURT EQUIPMENT IN THE PROJECT AREA WILL BE REMOVED BY THE LEON COUNTY SCHOOL BOARD.
2. THE CONTRACTOR IS TO FULLY RESTORE ANY AND ALL DAMAGE TO THE CHILES HIGH SCHOOL PROPERTY DUE TO CONSTRUCTION ACTIVITY.

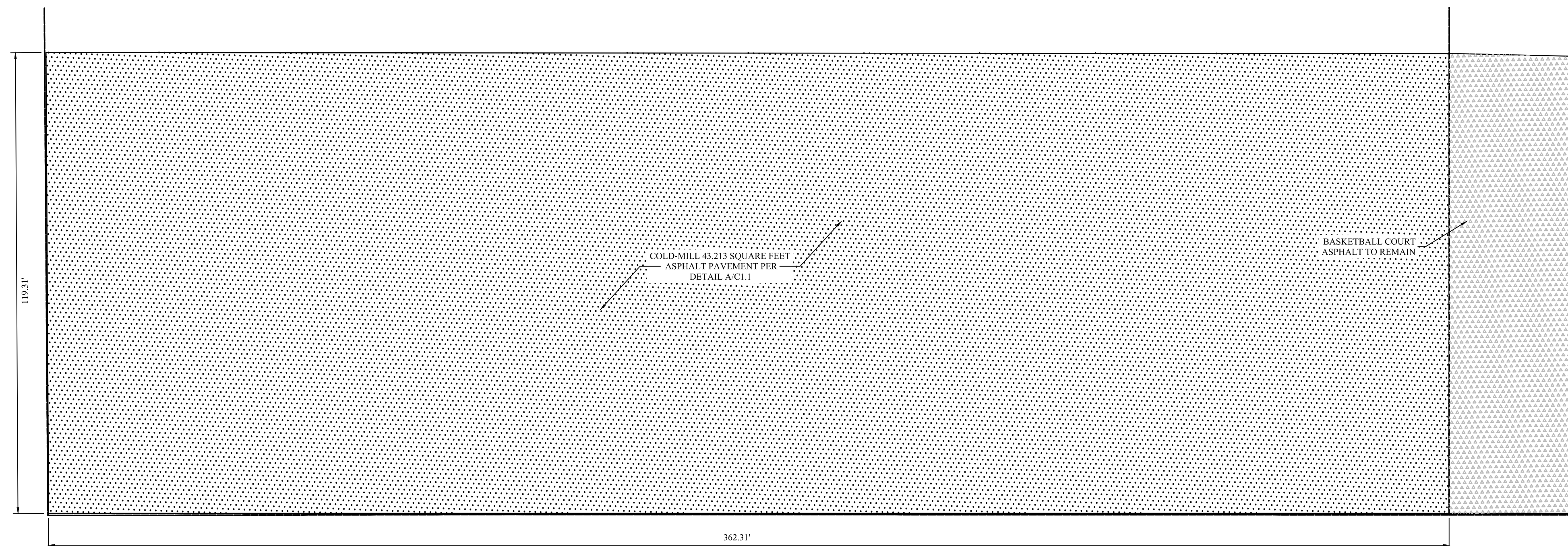

ASPHALT MILLING PLAN

1" = 20'

BID SET #2 09-25-18

DAVID H. MELVIN, INC.
 Consulting Engineers

EB-000567 LC-000077

TALLAHASSEE
 2541-1 BARRINGTON CIRCLE
 TALLAHASSEE, FLORIDA 32308
 Phone: 850.671.7221
 Fax: 850.671.7223

MARIANNA
 4428 LAFAYETTE STREET
 MARIANNA, FLORIDA 32446
 Phone: 850.482.3045
 Fax: 850.482.3957

**CHILES
 HIGH SCHOOL -
 TENNIS COURT
 MILLING &
 RESURFACING**

7200 LAWTON
 CHILES LANE
 TALLAHASSEE, FL

REVISIONS:

PROJECT NO: LSB18CHS
 DRAWING FILE:
 DRAWN BY: P. Davidson
 CHECKED BY: S. Martin
 DATE ISSUED: 08/30/2018

PAUL DAVIDSON, P.E.
 FLORIDA REG. NO. 84667

SHEET TITLE:
**ASPHALT MILLING
 PLAN**

SHEET NO:
C1.1

NOT FOR CONSTRUCTION
 RELEASED FOR CONSTRUCTION

© DAVID H. MELVIN, INC. ALL RIGHTS RESERVED. NO PART OF THIS DOCUMENT MAY BE REPRODUCED OR UTILIZED IN ANY FORM WITHOUT PRIOR WRITTEN PERMISSION OF DAVID H. MELVIN, INC.

LEGEND

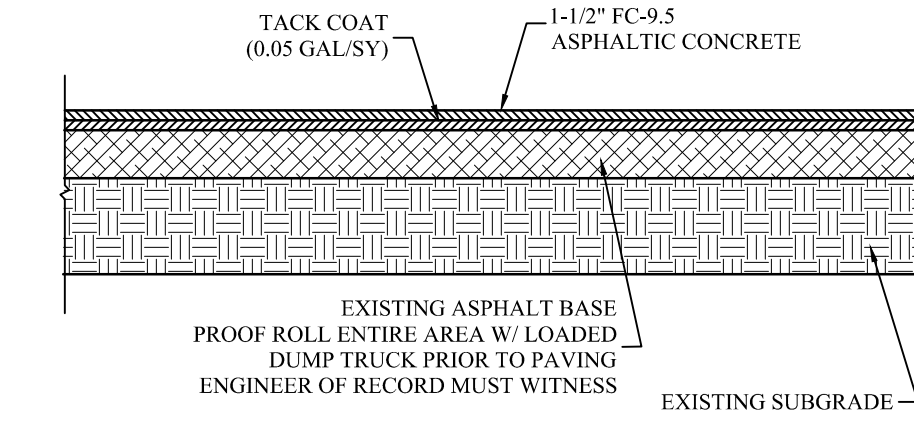
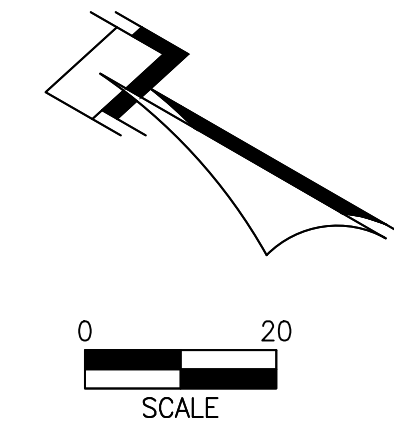
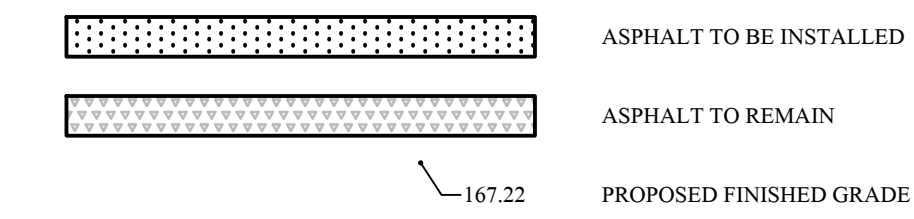

ASPHALT PAVING DETAIL
 A
 C2.0
 NTS

GENERAL NOTE:

1. THE EXISTING FENCES THAT RUN SOUTHWEST TO NORTHEAST, TENNIS COURT EQUIPMENT, AND TENNIS COURT STRIPING IN THE PROJECT AREA WILL BE REPLACED BY THE LEON COUNTY SCHOOL BOARD.
2. THE EXISTING FENCE POST AND TENNIS NET POST BASES WILL BE REMOVED BY THE LEON COUNTY SCHOOL BOARD. THE HOLES ARE TO BE FILLED WITH BASE AND MEET THE COMPACTION REQUIREMENTS OF FDOT STANDARD SPECIFICATIONS SECTION 285 OPTIONAL BASE GROUP 4. THE LEON COUNTY SCHOOL BOARD WILL BE RESPONSIBLE FOR PAYING FOR AND SCHEDULING ALL MATERIAL TESTING.
3. THE CONTRACTOR IS TO FULLY RESTORE ANY AND ALL DAMAGE TO THE CHILES HIGH SCHOOL PROPERTY DUE TO CONSTRUCTION ACTIVITY TO PRE-CONSTRUCTION CONDITIONS.
4. A PRE-CONSTRUCTION CONFERENCE IS TO BE SCHEDULED WITH THE ENGINEER OF RECORD (PAUL DAVIDSON, 850-228-2138) BEFORE ANY CONSTRUCTION ACTIVITY BEGINS.
5. THE ENGINEER OF RECORD (PAUL DAVIDSON, 850-228-2138) IS TO BE NOTIFIED 72 HOURS BEFORE PROOF ROLLING OF THE TENNIS COURT EXISTING BASE. THE ENGINEER OF RECORD MUST WITNESS THE PROOF ROLLING.

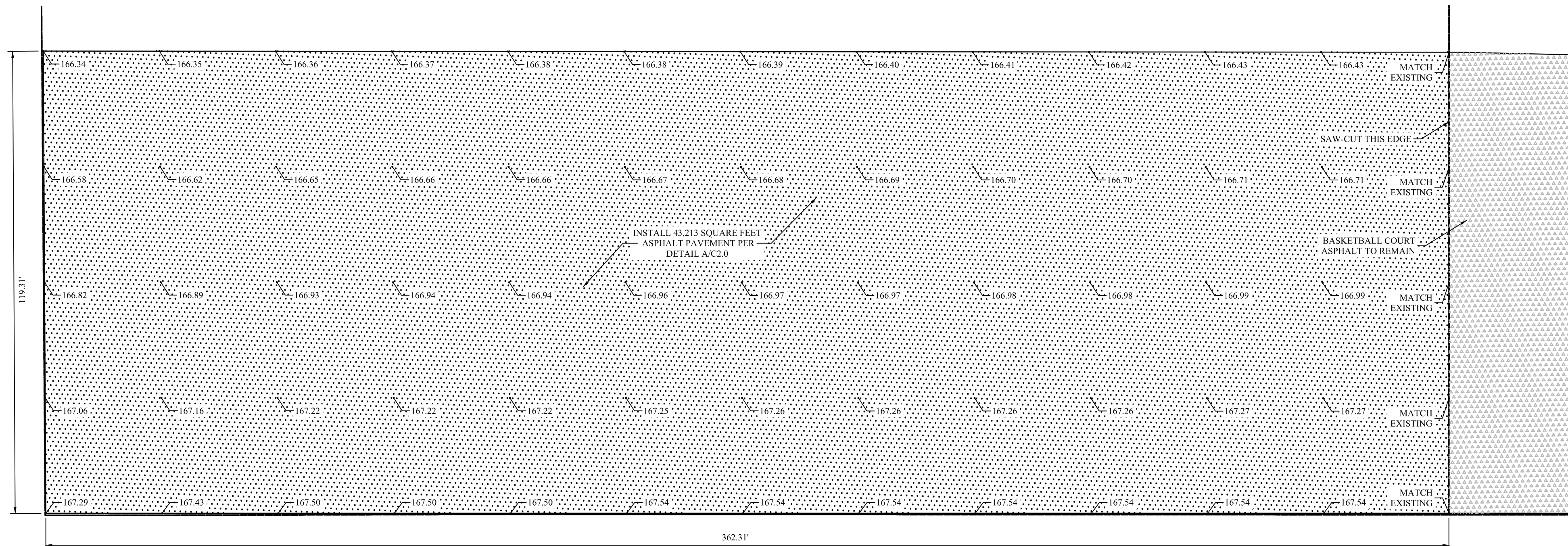

ASPHALT PAVING PLAN

1" = 20'

BID SET #2 09-25-18

CHILES HIGH SCHOOL - TENNIS COURT MILLING & RESURFACING

7200 LAWTON
 CHILES LANE
 TALLAHASSEE, FL

REVISIONS:

1 - PRE-BID ADDENDUM #2 09-25-18

PROJECT NO:	LSB18CHS
DRAWING FILE:	
DRAWN BY:	P. Davidson
CHECKED BY:	S. Martin
DATE ISSUED:	08/30/2018

PAUL DAVIDSON, P.E.
 FLORIDA REG. NO. 84687

SHEET TITLE:
ASPHALT PAVING PLAN

SHEET NO:
C2.0

X NOT FOR CONSTRUCTION
 RELEASED FOR CONSTRUCTION